

PLUNGER LUBE™ 612G

Features & Benefits

- Suitable for Aluminum & Zinc Casting
- Excellent Lubricating Properties under extreme pressure & high temperatures
- Prolongs Tip & Sleeve Life
- Minimizes Porosity Problems
- Minimal Staining of Metal Surfaces
- Easy to apply

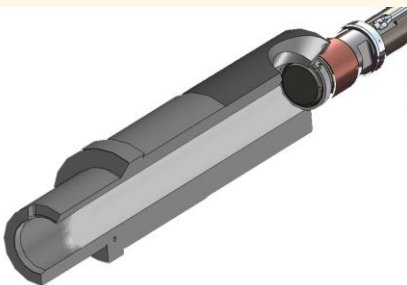

PRODUCT DESCRIPTION:

PLUNGER LUBE™ 612G is a blended water-based lubricant designed for superior tip and sleeve lubrication. It incorporates specialty blended synthetic / natural graphites to provide extra lubricity under high heat and pressure conditions. The product also contains a blend of wetting agents as well as proprietary thickening agents to prevent settling.

It is supplied ready for use and exhibits excellent cost / performance ratios.

TYPICAL CHARACTERISTICS:

FORM:	Liquid
APPEARANCE:	Black
ODOR:	Mild
FLASH POINT:	N/A
SPECIFIC GRAVITY:	1.01

APPLICATION:

Can be applied either through an automatic system or manually.

Excess amounts should be avoided as it can contribute to excessive staining or porosity.

Product is to be applied at full strength.

HEALTH & SAFETY

All reasonable care has been taken to ensure that the information contained in this publication is accurate as the date of printing, however, such information might change due to changes in the formulation blend occurring subsequent to the date of printing. The MSDS must be consulted for appropriate information regarding safe handling and storage.

